

Dimensions:mm

A:6.7(Max)

B:6.7(Max)

C:4.2 (Max)

D:9.5 (Max)

F:2.0(REF)

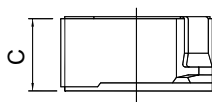

Electrical characteristics

Part No.	Inductance L (uH)	TESTING FREQ (KHZ)	DC RESISTANCE (OHM)Max	RATED DC CURRENT (A)Max
CDH6D38N-3R3□	3.3	100	20m	3.50
CDH6D38N-5R0□	5.0	100	24m	2.90
CDH6D38N-6R2□	6.2	100	27m	2.50
CDH6D38N-7R4□	7.4	100	31m	2.30
CDH6D38N-8R7□	8.7	100	34m	2.20
CDH6D38N-100□	10.0	100	38m	2.00
CDH6D38N-120□	12	100	53m	1.70
CDH6D38N-150□	15	100	57m	1.60
CDH6D38N-180□	18	100	92m	1.50
CDH6D38N-220□	22	100	96m	1.30
CDH6D38N-270□	27	100	0.109	1.20
CDH6D38N-330□	33	100	0.124	1.10
CDH6D38N-390□	39	100	0.138	1.00
CDH6D38N-470□	47	100	0.155	0.95
CDH6D38N-560□	56	100	0.202	0.85
CDH6D38N-680□	68	100	0.234	0.75
CDH6D38N-820□	82	100	0.324	0.70
CDH6D38N-101□	100	100	0.358	0.65

□:M=±20% P=±30%